

# The Duesbury



Preliminary computer generated image of The Duesbury (subject to change)

Plot 445, (446 is handed)

## GROUND FLOOR

LIVING/DINING AREA	6500MM X 3250MM	21'5" X 10'8"
KITCHEN	4650MM X 2400MM	15'3" X 7'10"

## FIRST FLOOR

MASTER BEDROOM	5250MM X 3250MM	17'2" X 10'8"
BEDROOM 2	3600MM X 3300MM	11'9" X 10'10"
BEDROOM 3	3450MM X 3150MM	11'3" X 10'4"



## PRELIMINARY INFORMATION

All sizes are approximate with maximum dimensions given. They have been taken into the kitchen units and are not intended for carpet sizes or items of furniture. Countryside Properties operates a policy of continuous product development and all room layouts may be subject to minor modifications. All dimensions and areas listed are to structural measurements, not finished measurements. Please ask Sales Consultants for detailed information regarding specific properties.

SECOND FLOOR

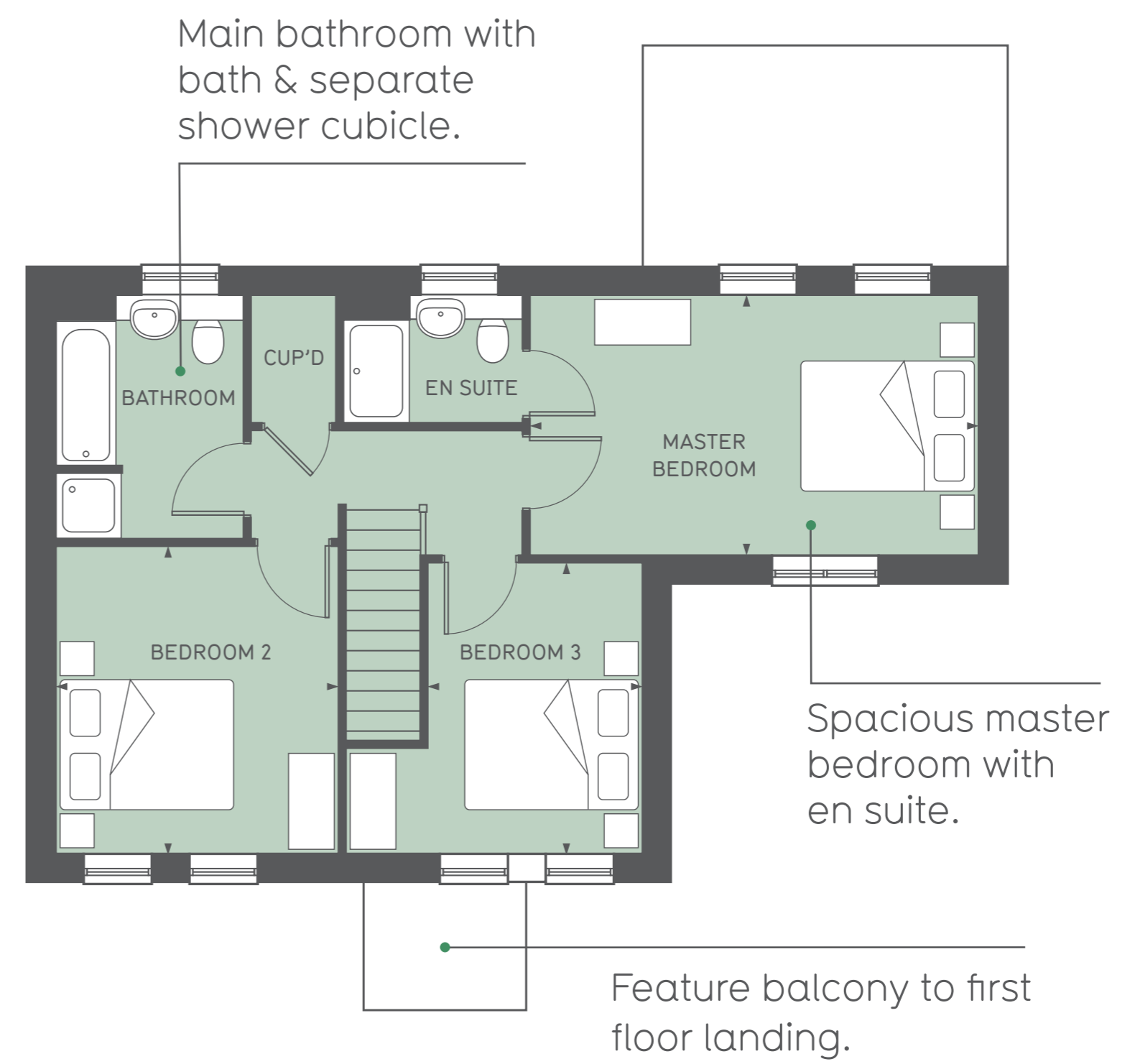

GROUND FLOOR

